



TOWN OF MINTO

DATE: June 29, 2017
REPORT TO: Mayor and Council
FROM: Bill White C.A.O. Clerk
SUBJECT: Pedestrian Crossovers

STRATEGIC PLAN:

11.3 Develop a transportation plan that includes a roads and bridges inventory and capital replacement program keeping in mind sustainable funding sources, impact on tax rate, and minimum construction and maintenance standards.

BACKGROUND:

At the May 2 Council meeting Wellington Safe Communities gave an overview of new standards for School Crossings, Crosswalks and Pedestrian Crossovers. Safe Communities recommended all local municipalities change to the new standard in 2017 to ensure a consistent standard across the County. In 2017 funds were budgeted for a pedestrian crossing at Main Street and William in Palmerston. This crossing must be constructed according to the new standard.

To ensure proper design at all pedestrian crossovers in Minto are installed according to County and Provincial requirements, Triton Engineering evaluated each site to assess technical traffic requirements. Howard Wray from Triton Engineering will be appearing as a delegation at the July 4 meeting to explain the standards. Any new crossing that meets warrants specified in the Ontario Traffic Manual and where the County approves its installation by a local municipality, the County will assume and maintain the crossing.

Council is asked to pass a resolution indicating the Town wants to have current School Crossings on County Roads, changed to Pedestrian Crossings with appropriate signage and painting as per the Ontario Traffic Manual.

COMMENTS:

The Town has six crossings in the Minto eligible for the new standard:

Palmerston

1. Prospect St (Town Road) at east entrance to Palmerston Public (1 Crossing Guard)
2. Toronto St (County Road) and Prospect St (Town Road) (1 Crossing Guard both crossings)
3. Main St (County Road) and Brunswick St (Town) (1 Crossing Guard)

Harriston

4. Arthur St (Connecting Link) and George St (Town Road) (1 Crossing Guard)
- 5a) Current crossing Elora St (Connecting Link) and Union St (Town Road) (1 Crossing Guard)
- 5b) Relocate crossing Elora St (Connecting Link) & William St (Town Road) 1 (Crossing Guard)

6. New crossing Main (County Road) and William St built by Minto assumed by County

The following shows the design of the new crossing at Main Street in Palmerston:

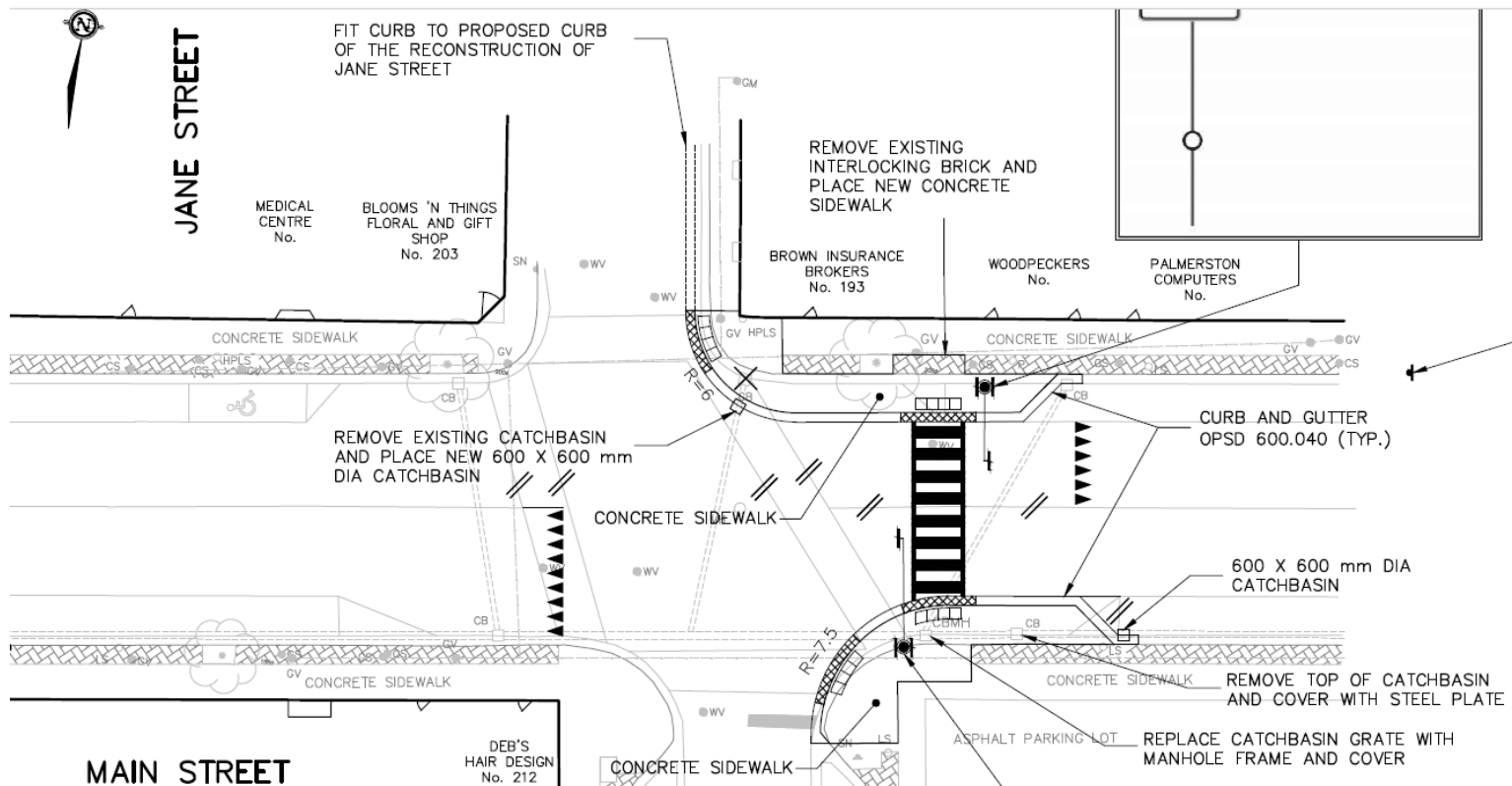

County Staff has reviewed this design and provided comments to Triton Engineering. There are other options but Town staff and Triton are recommending Council proceed with the design shown above. The intent is to have the installation completed as soon as the work can be quoted and awarded.

Council should also be aware of the relocation of the crossing on Elora Street (Highway 9) from Union to William Street. The current crossing directs students down Union to the old walkway location through the Senior School. Re-development of the Senior School has relocated the crossing. The proposed crossing location at William Street provides better visibility on the highway and is compliant with the Ontario Traffic Manual.

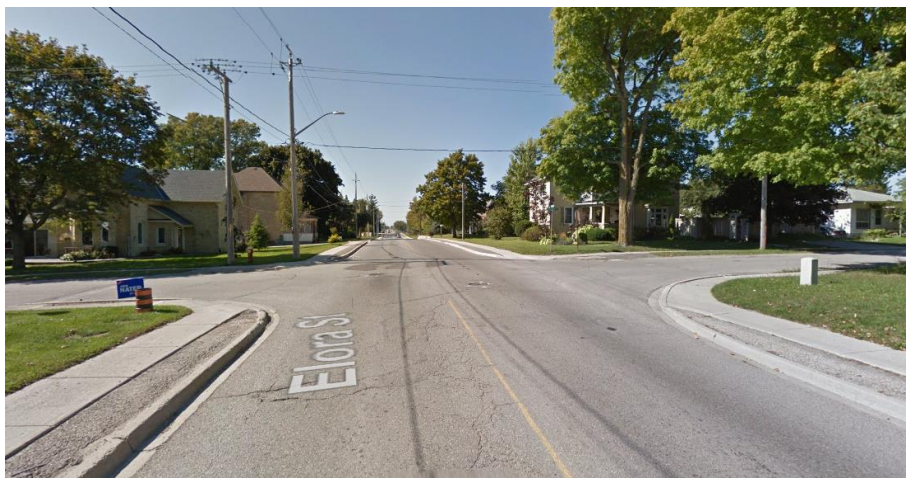

Sidewalks have been constructed northwesterly down William Street to the walkway to Minto Clifford Public School. This is a more direct and safer route for children to cross. Staff will be advising the School Board and administration of the change once the crossing has Provincial approval.

FINANCIAL CONSIDERATIONS:

The Town will cover line painting and signage for the five regular crossing out of its operating budget. Line painting is delayed in these areas pending a decision on the crossovers. \$10,000 is set in the budget for the new crossing at Main and William Street in Palmerston. The final cost of the work is not confirmed, but added curb work could be attributed to the Jane Street Reconstruction project already underway across from William Street.

RECOMMENDATION:

That Council receives the C.A.O. Clerk's and Road Foreman's June 30, 2017 report and the delegation from Howard Wray of Triton Engineering and directs staff to proceed to implement new pedestrian crossovers as follows:

1. Prospect Street (Town Road) at east entrance to Palmerston Public
2. Palmerston Toronto Street (County Road) and Prospect Street (Town Road)
3. Palmerston Main Street (County Road) and Brunswick Street (Town)
4. Harriston Arthur Street (Connecting Link) and George Street (Town Road)
5. Relocate current crossing Elora Street (Connecting Link) and Union Street (Town Road) to Elora St (Connecting Link) & William St (Town Road)
6. Palmerston Main Street (County Road) and William Street to be built by Town of Minto and assumed by County of Wellington.

subject to compliance with the Ontario Traffic Manual and approval by the appropriate road authority.

Bill White C.A.O. Clerk

Mike McIsaac Road Foreman